

- LEGEND**
1. Access floor panel
 2. M6 x 45mm nickel chrome plated stringer screw
 3. 4mm thick die formed nickel chrome plated steel head
 4. Hot dipped galvanized steel box stringer with factory applied foam gasket.
 5. Steel stud
3/4" - 10 UNC
 6. Nut with vibration proof locking device
 7. Type 1A base with 22mm sq. x 16 ga. wall nickel chrome plated tubing
 8. 100mm square x 2mm thick die formed embossed nickel chrome plated steel base plate
 9. Resistance Weld

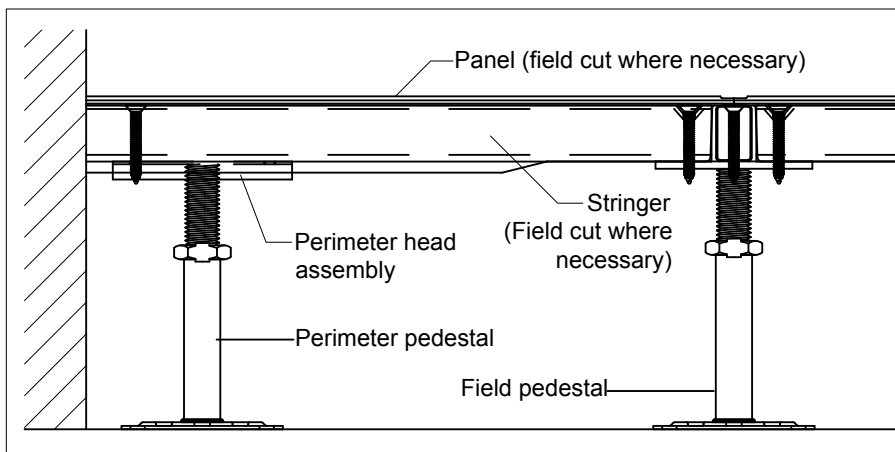

PEDESTAL SPECIFICATIONS

Pedestal Assembly

- Assembly up to 900mm FFH shall provide a minimum 2270 kg axial load without permanent deformation.
- Assembly shall provide a 50mm total adjustment with a minimum finished floor height of 180mm.
- Standard finished floor heights of 150mm to 900mm. For lower finished floor heights and seismic concerns, refer to low FFH and seismic submittal details.
- All pedestal components and fasteners are completely electro-zinc free.
- Zinc electroplating shall be prohibited on all pedestal components and fasteners.

Pedestal Head

- 4mm thick die formed nickel chrome plated steel pedestal head resistance welded to a threaded rod with adjustment nut. Head and installed stringers to provide full perimeter edge support for panel.
- Stringers shall be attached with M6 flat head screws.
- Pedestal head shall be tapped for engagement of stringer screws.
- Solid steel stud shall be 3/4" - 10 UNC.
- Nickel chrome plated nut shall be 3/4" - 10 UNC and shall include an anti-rotation feature when engaged onto the base assembly.
- Stud shall provide an anti-rotation feature when engaged with the pedestal base assembly. (180mm FFH or higher)

Pedestal Base

- Base to be at least 100cm² and nickel chrome plated steel with (4) 11mm diameter holes for mechanical fastening applications
- Pedestal tube shall be 22mm square x 16 ga. wall nickel chrome plated tubing.

Stringers

- Heavy duty steel box stringer shall be 32mm deep x 21mm wide with factory applied foam gasket and shall withstand 200kg mid-span load.
- Stringer shall have hot dipped galvanized coating to prevent corrosion.
- Stringer grid pattern shall be 60cm x 60cm, 60cm x 120cm or 120cm x 120cm basketweave.

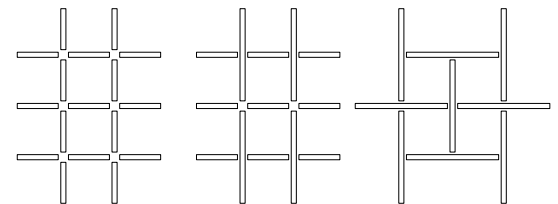

Perimeter

- Perimeter pedestal shall provide support for panels around columns, at walls and in corners.