

PEDESTAL SPECIFICATIONS

Pedestal Assembly

- Assembly from 75mm to 115mm FFH shall provide a minimum 2270 kg axial load without permanent deformation.
- 75mm FFH shall provide a 5mm total adjustment with a minimum finished floor height of 70mm.
- 100mm FFH shall provide a 15mm total adjustment with a minimum finished floor height of 85mm.
- 115mm FFH shall provide a 20mm total adjustment with a minimum finished floor height of 95mm.
- All pedestal components and fasteners are completely electro-zinc free.
- Zinc electroplating shall be prohibited on all pedestal components and fasteners.

Pedestal Head

- 4mm thick die formed nickel chrome plated steel pedestal head fillet welded to an internally threaded ferrule. Head and installed stringers to provide full perimeter edge support for panel.
- Stringers shall be attached with M6 flat head screws.
- Pedestal head shall be tapped for engagement of stringer screws.

Pedestal Base

- Base to be at least 100cm² and nickel chrome plated steel with (4) 11mm diameter holes for mechanical fastening applications
- Solid steel stud shall be 3/4" - 10 UNC and resistance welded to base plate.

Stringers

- Heavy duty steel box stringer shall be 32mm deep x 21mm wide with factory applied foam gasket and shall withstand 200kg mid-span load.
- Stringer shall have hot dipped galvanized coating to prevent corrosion.
- Stringer grid pattern shall be 60cm x 60cm, 60cm x 120cm or 120cm x 120cm basketweave.

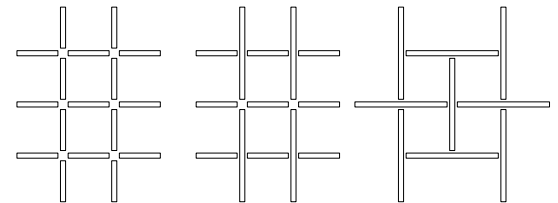
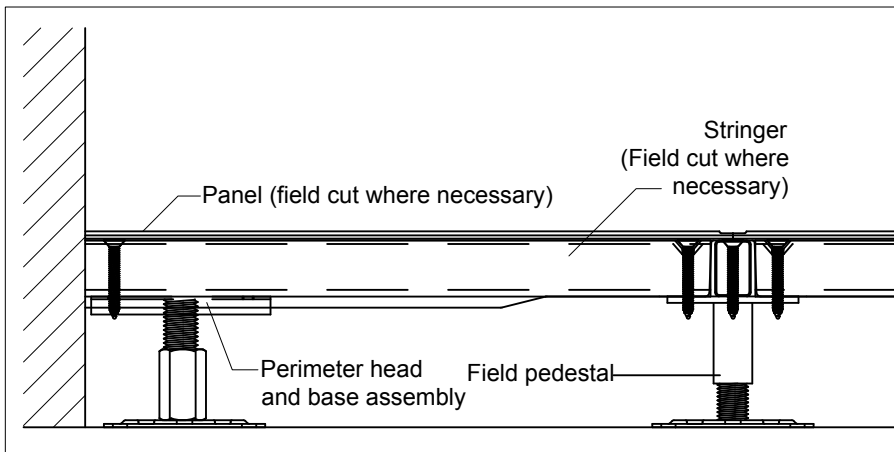

Perimeter

- Perimeter pedestal shall provide support for panels around columns, at walls and in corners.