

SPECIFICATIONS

General information

- Pre-assembled panels and supplied brackets make for quick installation
- Compression gaskets efficiently seal and minimize air leakage
- Multiwall option adheres to 2013 NFPA 75 flame spread and smoke development requirements
- Custom sized for every job, 1.22 m max width x 2.43 m max height
- Designed to work with ContainAire® Single and Dual Doors
- Sturdy aluminum framing
- Fully supported by server cabinet and ContainAire® Doors, if available
- Hard partitions with multiwall polycarbonate are listed in UL file SA44425

Dimensions

- 121.9 cm max width x 243.8 cm max height x 4.0 cm depth

OPTIONS

Panel Options

- Clear Polycarbonate
 - Fully transparent
 - ASTM D-635 listed
 - 6mm thick with edge sealing gaskets
- Multiwall Polycarbonate
 - Semi-transparent
 - Flame spread index <50
 - Smoke development <450
 - ASTM E-84 and ASTM D-635 listed
 - UL 94 listed
 - 8mm thick

Aluminum Extrusion Finish Options

- Black Painted
- Gray Painted
- White Painted

INCLUDED COMPONENTS

- Hard Partition
- Mounting hardware
- Foam gasket with adhesive back
- Installation guide



Hassle free installation
(corner detail shown)

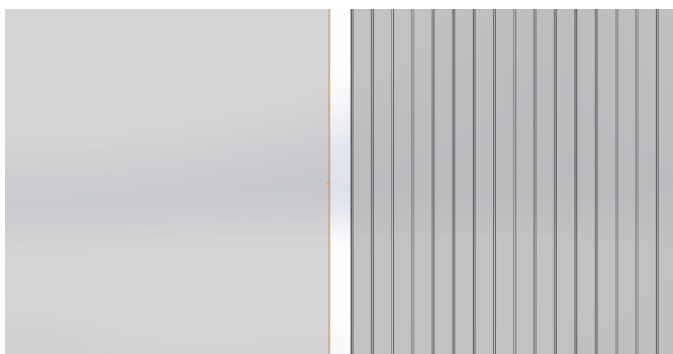

Polycarbonate
Clear/Transparent

Polycarbonate
Semi-transparent/Multiwall

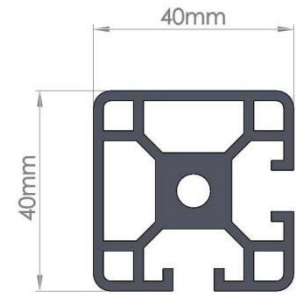

Custom Extrusion Profile

Typical Hard Partition installation with aisle end
Single Door option

PART NUMBERS

