

## PEDESTAL SPECIFICATIONS

### Pedestal Assembly

- Assembly from 75mm to 115mm FFH shall provide a minimum 2270 kg axial load without permanent deformation.
- 75mm FFH shall provide a 5mm total adjustment with a minimum finished floor height of 70mm.
- 100mm FFH shall provide a 15mm total adjustment with a minimum finished floor height of 85mm.
- 115mm FFH shall provide a 20mm total adjustment with a minimum finished floor height of 95mm.

### Pedestal Head

- 4mm thick die formed white zinc coated steel pedestal head fillet welded to an internally threaded ferrule. Head and installed stringers to provide full perimeter edge support for panel.
- Stringers shall be attached with M6 flat head screws.
- Pedestal head shall be tapped for engagement of stringer screws.
- Pedestal head shall have tapped holes for engagement of cornerlock screws and shall incorporate locating points to laterally contain and positively position the floor panel with or without the use of screws.
- Cornerlock fastener shall be M6 flat-head machine screw.

### Pedestal Gasket

- Pedestal head gasket shall engage with stringers and panel to form a UFAD air seal

### Pedestal Base

- Base to be at least 100cm<sup>2</sup> and white zinc coated steel with (4) 11mm diameter holes for mechanical fastening applications
- Solid steel stud shall be 3/4" - 10 UNC and resistance welded to base plate.

### Stringers

- Heavy duty steel box stringer shall be 32mm deep x 21mm wide with factory applied foam gasket and shall withstand 200kg mid-span load.
- Stringer shall have hot dipped galvanized coating to prevent corrosion.
- Stringer grid pattern shall be 60cm x 60cm

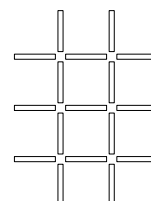
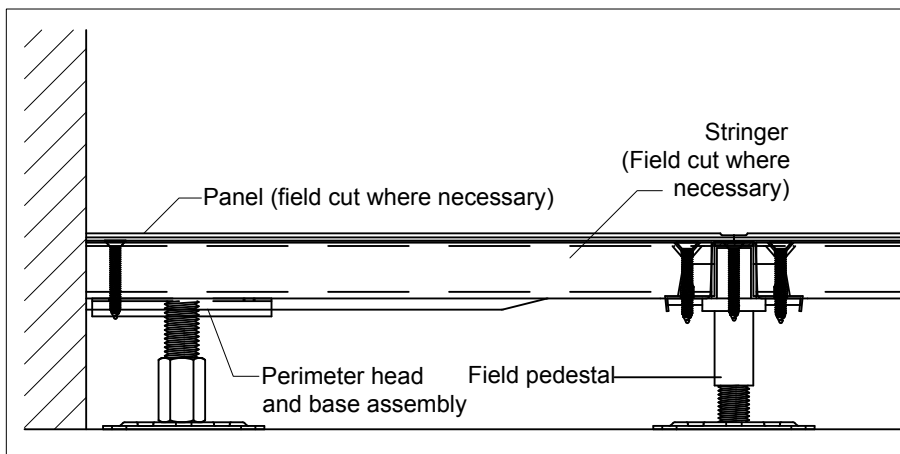

### Perimeter

- Perimeter pedestal shall provide support for panels around columns, at walls and in corners.